

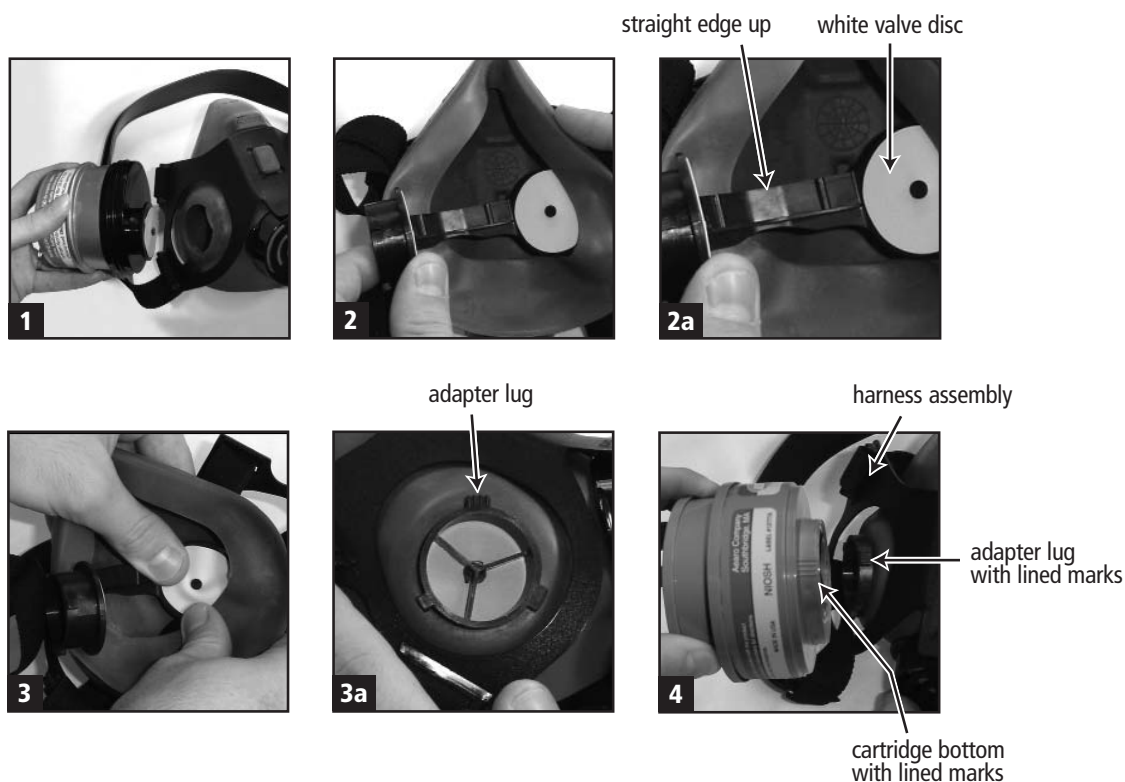

**NEW & IMPROVED**  
**PLASTIC CARTRIDGES REPLACE METAL, THREADED CARTRIDGES.**  
**FOLLOW THE EASY ASSEMBLY INSTRUCTIONS BELOW.**

**New** plastic cartridges & adapter assembly is lighter weight and easier to breathe through. It's easy to convert your AOSafety respirator with metal cartridges to the new plastic cartridges. Just use the conversion adapter packaged with AOSafety replacement cartridges and follow the simple instructions below. Once you have installed the conversion adapter in your AOSafety mask you do not have to re-install next time you buy replacement cartridges. The adapter stays affixed in your mask for future use.

- Step 1:** Pull out both threaded cartridge and holder from the mask and discard (Figure 1).
- Step 2:** Place mask on flat surface. Insert black adapter horizontally inside the mask (Figure 2) so that the straight edge is facing up. Be sure white valve discs are on the adapter (Figure 2a).
- Step 3:** Press round adapter connector through mask hole using both thumbs (Figure 3) until you hear it snap into place. Repeat on other side. Keep adapter in the mask for future use with plastic replacement cartridges. Be sure rubber around mask holes seals snugly under the 3 adapter lugs (Figure 3a).
- Step 4:** To attach new plastic cartridges hold harness assembly flat against mask. Match up the lined marks on the cartridge bottom with the lined marks on the adapter lug (Figure 4). Push the cartridge down and turn it clockwise  $\frac{1}{4}$  turn to snap it into place. Be sure all 3 lugs from the new adapter are engaged into the cartridge as it snaps into place.



**For Technical Support call us at 1-800-444-4774.**